

The Public Land Survey System (PLSS)

Terms and Definitions

- **Initial Point:** The starting point for a survey; the intersection of the Principal Meridian and the Baseline in a given region
- **Principal Meridian:** A true meridian, or line of longitude, running through an initial point, which together with the baseline forms the highest level framework for all rectangular surveys in a given area
- **Baseline:** A parallel of latitude, referenced to and established from a designated initial point, upon which all rectangular surveys in a defined area are based
- **Cadastral:** Having to do with the boundaries of land parcels
- **Latitude:** A geographic coordinate that specifies the north-south position of a point on the earth's surface. Lines of latitude (or **parallels**) are circles running east-west parallel to the equator. The equator is the origin (0 degrees) of latitude.
- **Longitude:** A geographic coordinate that that specifies the east-west position of a point on the earth's surface. Lines of longitude run from the North Pole to the South Pole and converge at the poles. The Prime Meridian is the origin for longitude (0 degrees); it passes through Greenwich, England.
- **Township:** 1) A survey township; a square parcel of land of 36 square miles (sections)
2) A measure of the distance north or south from a reference baseline, in units of six miles.
- **Range:** A measure of the distance east or west from a principal meridian, in units of six miles.
- **Section:** An approximately one square mile (640 acre) block of land. There are 36 sections in a survey township.
- **Aliquot Part:** A regular parcel of land, the reference to which has the successive subdivisions of a larger parcel appended to the beginning.

Example: SW ¼ NW ¼ S13, T1SR20E refers to the aliquot part that is the southwest quarter of the northwest quarter of Section 13 of Township 1 South Range 20 East, a 40 acre parcel.

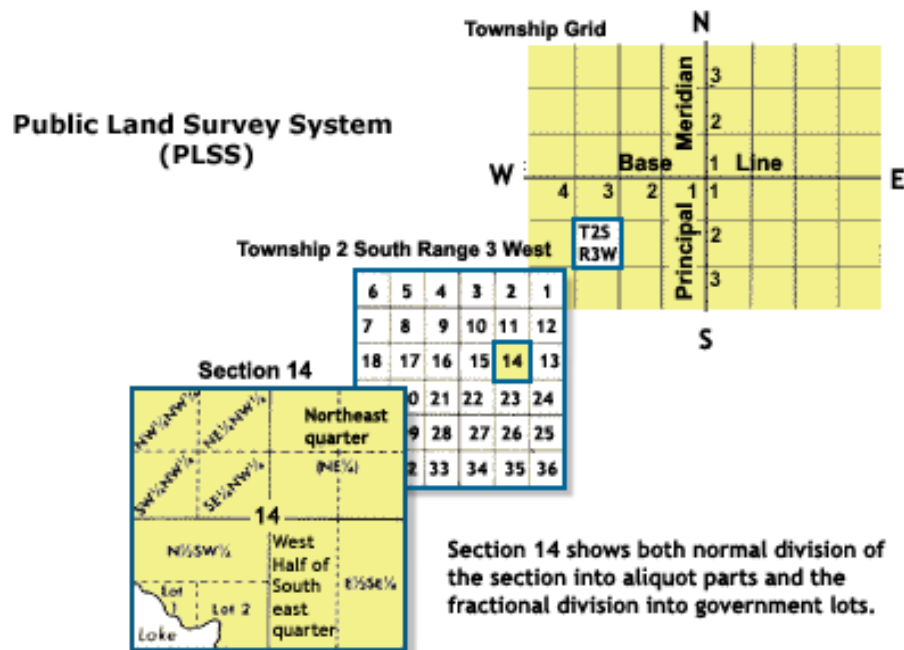

6	5	4	3	2	1
7	8	9	10	11	12
18	17	16	15	14	13
19	20	21	22	23	24
30	29	28	27	26	25
31	32	33	34	35	36

Section Numbering

Sample Test Question: What is the section that is due west of S19, T7SR14E?

Answer: S24, T7SR13E